

BW 4D DC (12V200Ah)

SPECIFICATIONS

Nominal Voltage		12 V
Capacity (25°C)	20HR	200 Ah
	5HR	167 Ah
	1HR	117 Ah
Dimension	Length	522 ± 2mm (20.55inch)
	Width	238 ± 2mm (9.37inch)
	Height	218 ± 2mm (8.58inch)
	Total Height	221 ± 2mm (8.70inch)
Approx. Weight		57kg (125.40lbs) ± 4%
Terminal type		F13(M8)
Internal resistance (Fully charged, 25°C)		Approx. 3m Ω
Capacity affected by temperature (10HR)	40°C	102%
	25°C	100%
	0°C	85%
	-15°C	65%
Self-discharge (25°C)	3 month	Remaining Capacity: 91%
	6 month	Remaining Capacity: 82%
	12 month	Remaining Capacity: 65%
Nominal operating temperature		25°C ± 3°C (77°F ± 5°F)
Operating temperature range	Discharge	-15°C ~ 50°C (5°F ~ 122°F)
	Charge	-10°C ~ 50°C (14°F ~ 122°F)
	Storage	-20°C ~ 50°C (-4°F ~ 122°F)
Float charging voltage(25°C)		13.50 to 13.80V Temperature compensation: -18mV/°C
Cyclic charging voltage(25°C)		14.50 to 15.00V Temperature compensation: -30mV/°C
Maximum charging current		57A
Maximum discharge current		1520 A(5 sec.)
Designed floating life(20°C)		10 years



DIMENSIONS

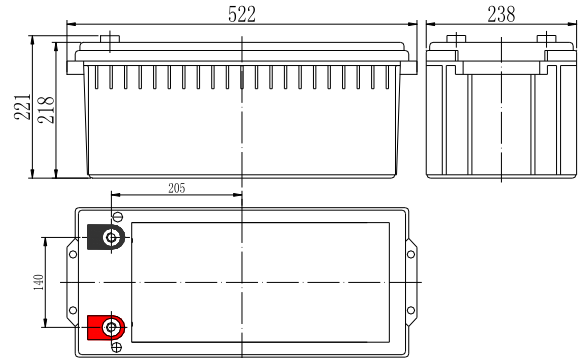

TERMINAL

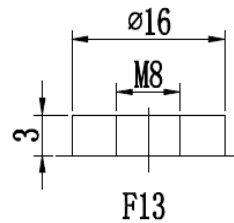

CONSTRUCTION

Component	Positive plate	Negative plate	Container	Cover	Separator	Electrolyte	Safety valve	Terminal
Raw material	Lead dioxide	Lead	ABS	ABS	AGM	Sulfuric acid	Rubber	Copper

CONSTANT CURRENT DISCHARGE CHARACTERISTICS (A, 25°C)

F.V/TIME	10min	15min	30min	60min	2h	3h	4h	5h	8h	10h	20h
9.60V	414	319	191	118	69.4	49.4	39.9	34.1	23.5	19.4	10.3
9.90V	402	312	187	116	69.0	49.1	39.7	33.9	23.3	19.3	10.2
10.2V	425	300	181	113	68.4	48.8	39.4	33.6	23.2	19.3	10.1
10.5V	407	290	177	110	67.3	48.4	39.1	33.4	23.0	19.1	10.1
10.8V	384	275	170	107	65.6	47.0	38.0	32.4	22.3	19.0	10.0

CONSTANT POWER DISCHARGE CHARACTERISTICS (WATT, 25°C)

F.V/TIME	10min	15min	30min	60min	2h	3h	4h	5h	8h	10h	20h
9.60V	4473	3504	2142	1338	804	581	469	403	278	231	122
9.90V	4339	3420	2099	1319	799	577	466	401	277	230	121
10.2V	4160	3295	2035	1285	792	573	464	398	275	229	121
10.5V	3981	3182	1986	1258	780	570	461	395	273	228	120
10.8V	3757	3014	1913	1220	760	553	446	384	265	227	120.5

Note: The above characteristics data can be obtained within three charge/discharge cycles.

Discharge Characteristics (25°C)

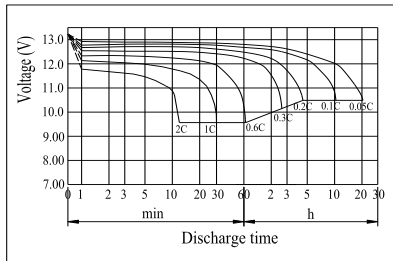

Charging Characteristics (25°C)

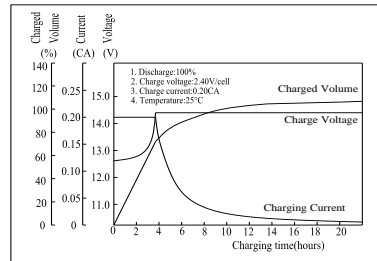

The Relationship for Open Circuit Voltage and Residual Capacity (25°C)

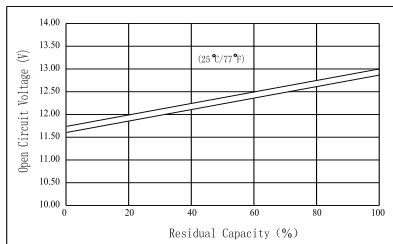

The Relationship for Charging Voltage and Temperature

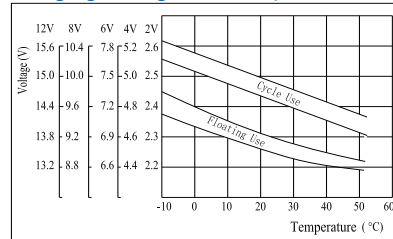

Floating Life on Temperature

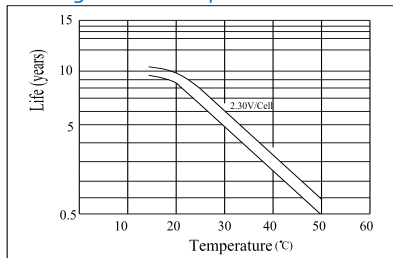

Cycle Life on D.O.D (25°C)

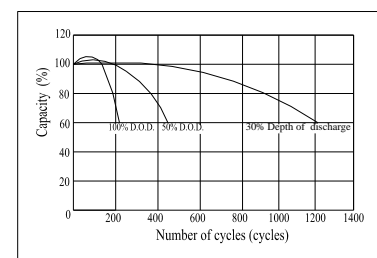

Effect of Temperature on Capacity

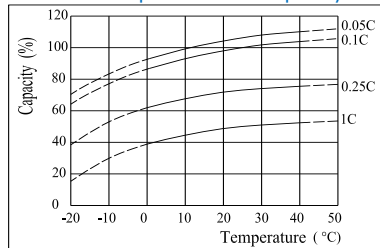

Self-discharge Characteristics

